

200WD18 Ductile Iron Gate Valve • Spec Sheet

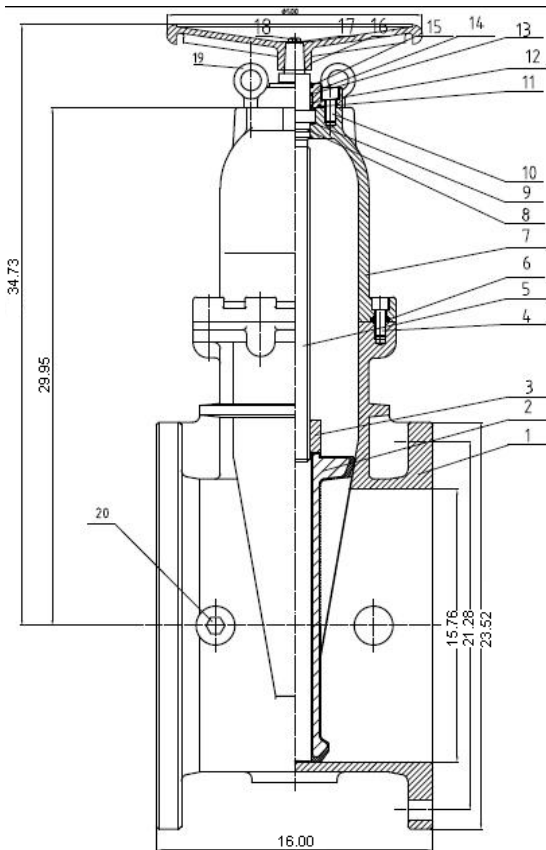

FEATURES & BENEFITS

- Gate Valve-Flanged Ends
- ISO-9002
- 200 CWP
- Fusion Bonded Epoxy Coating - AWWA C550
- Resilient Wedge
- Non Rising Stem
- Bolted Bonnet
- Handwheel
- Meets AWWA C-515 standard
- Flanged Ends Conform with ANSI B16.1
- Size - 16"



MATERIAL SPECIFICATIONS

No.	Part	Material
1	Body	Ductile Iron ASTM A536
2	Wedge	EPDM ASTM D2000
3	Stem Nut	Bronze ASTM B584
4	Screw	Steel ASTM A574M
5	Stem	Stainless Steel AISI 410
6	Bonnet Gasket	EPDM ASTM D2000
7	Bonnet	Ductile Iron ASTM A536
8	O-Ring	EPDM ASTM D2000
9	Washer	Bronze ASTM B584
10	Screw	Steel ASTM A574M
11	O-Ring	EPDM ASTM D2000
12	Seal Bushing	Bronze ASTM B584
13	O-Rings	EPDM ASTM D2000
14	Gland Bushing	Ductile Iron ASTM A536
15	Ring Wiper	EPDM ASTM D2000
16	Cap	Ductile Iron ASTM A536
17	Flat Washer	Stainless Steel AISI SS304
18	Screw	Stainless Steel AISI SS304



CALIFORNIA 5595 Fresca Dr., La Palma CA 90623
TEXAS 1150 Silber Rd., Houston TX 77055
ILLINOIS 278 Windy Point Dr., Glendale Heights, IL 60139
GEORGIA 113 Industrial Blvd., Americus, Georgia 31709
NEW YORK PO Box 27, Rt.22, Brewster NY 10509
 WEB: www.matco-norca.com

• Phone: 866-532-8306 • Fax: 866-532-8307
 • Phone: 800-935-5456 • Fax: 713-680-2999
 • Phone: 844-412-5068 • Fax: 800-640-2252
 • Phone: 800-433-7526 • Fax: 800-533-5134
 • Phone: 800-431-2082 • Fax: 845-278-9056
 EMAIL: mail@matco-norca.com