

# AE-945 Two Handle Faucet • Spec Sheet

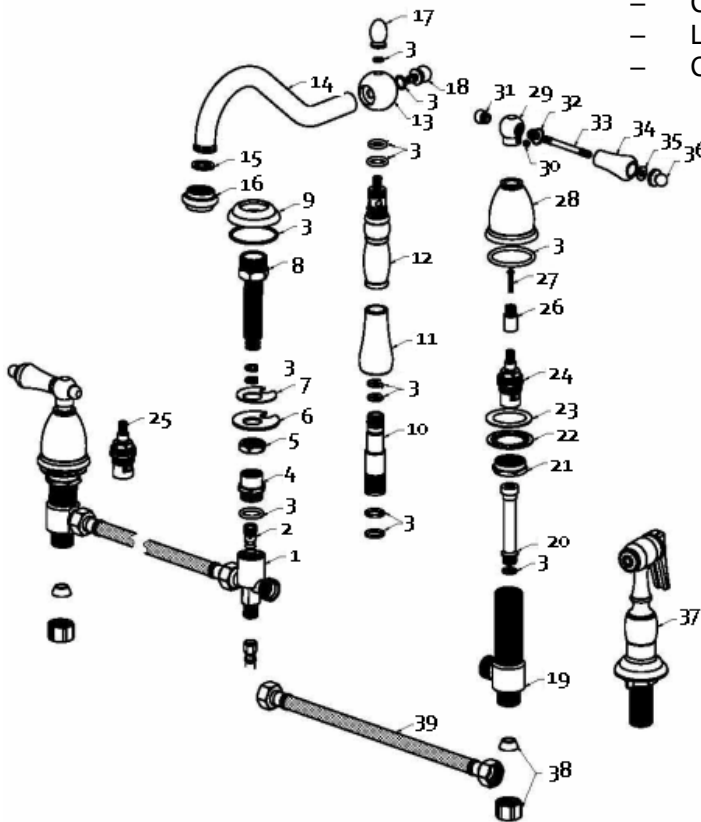

## FEATURES & BENEFITS

- 8" Concealed Deck Kitchen Faucet
- Chrome Plate
- Lever Handles
- Ceramic Cartridge



## MATERIAL SPECIFICATIONS

No.	Part Name	No.	Part Name
1	Three Exchange Connector	17	Solid Decorative Body
2	Water Knockout Drum	18	Brass Decorative Body
3	O- Rings	19	Brass Valve Body
4	Connector	20	Separation Connector
5	Hex Nut	21	Lock Nut
6-7	Deck Gasket	22	Basin Rosette
8	Brass Hex Body	23	Deck Gasket
9	Escutcheon Ring	24-25	Cartridge
10	Middle Brass Body	26	Cartridge Connector
11	Middle High Cap	27	Screw
12	Brass Outer Connector	28-36	Polished Brass & Satin Nickel Lever Handle with Set Screw
13	Spout Connector Ball		
14	Spout	37	Spray
15	Aerator Gasket	38	Cone Washer & Brass Supply Nut
16	Aerator	39	Hose

**MATCO-NORCA**  
 Global sourcing. National compliance. Local service.

**NEW YORK**  
**CALIFORNIA**  
**TEXAS**  
 WEB: [www.matco-norca.com](http://www.matco-norca.com)

PO Box 27, Rt.22, Brewster NY 10509 • Toll Free: 800-431-2082 • Fax: 845-278-9056  
 5593 Fresca Dr., La Palma CA 90623 • Toll Free: 866-532-8306 • Fax: 714-522-3828  
 1150 Silber Rd., Houston TX 77055 • Toll Free: 800-935-5456 • Fax: 713-680-2999  
 EMAIL: [mail@matco-norca.com](mailto:mail@matco-norca.com)