

TWHK04T Tankless Water Heater Isolation Valve Kit

Specification Sheet

FEATURES & BENEFITS

- 600# Rating (Non-Shock)
- Full Port, 1/4 Turn Design
- Blow-Out Proof Stem
- Adjustable Packing
- Integral Hose End Drain / Purge Port with Cap
- NSF372, NSF61, NSF14, cUPC & IAPMO Z1157 Approved
- Available in: Union X Threaded

Pressure Relief Valve:

- 150 PSI Rated @ 500,000 btu/hr
- Pressure Relief Valve is ASME Section IV, ANSI Z21.22 and CSA 4.4 Certified
- Size 3/4"



MATERIAL SPECIFICATIONS

No.	Part	Material
1	Screw	Steel
2	Washer	Steel
3	Blue Handle	Aluminum
4	Packing Nut	Brass
5	Packing Gland	PTFE
6	Washer	PTFE
7	Stem	C46500
8	Body	C46500
9	Seat	PTFE
10	Ball	C46500
11	Bonnet	C46500
12	Connection Cap	Brass
13	Snap Ring	Stainless Steel
14	Gasket	EPDM
15	Joint	C46500
16	Screw	Steel
17	Bule Handle	Aluminum
18	Stem	C46500
19	O-Ring	EPDM
20	Seat	PTFE
21	Ball	C46500
22	Locking Cap	C46500
23	Gasket	EPDM
24	Plug Cap	Brass
25	White Strip	PVC
26	Red Handle	Aluminum
27	Body	C46500
28	Red Handle	Aluminum

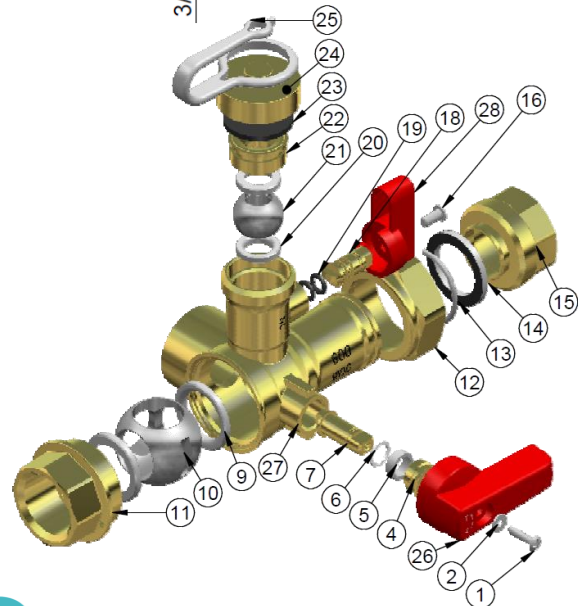
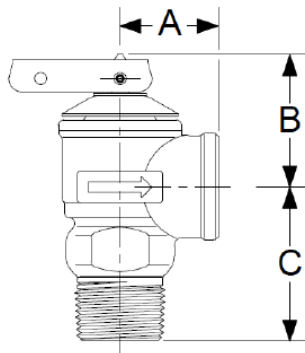
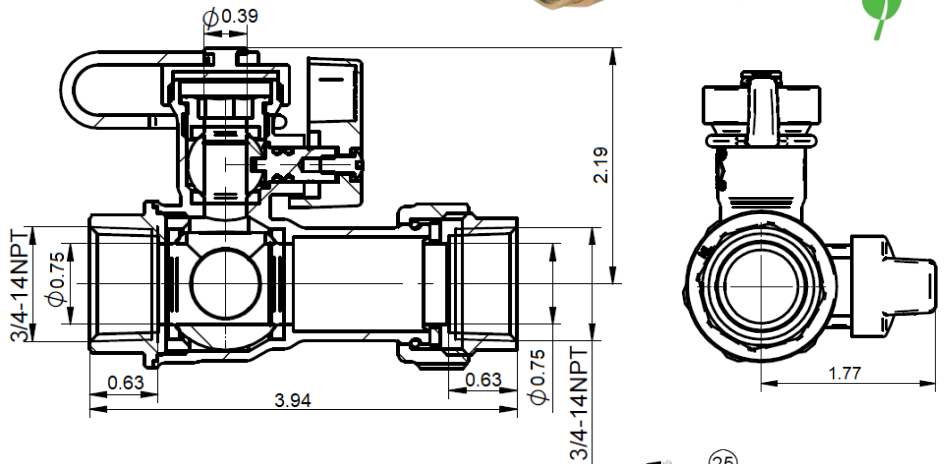

PRESSURE RELIEF VALVE

Part	Material
Body	Bronze
Internal Parts	Brass & Stainless Steel
Seat Disc	Silicone
Pressure Spring	Stainless Steel

DIMENSIONS

Size	A	B	C
3/4"	1-5/32"	1-9/16"	1-25/32"

