

IBILLF & IBLRLF Brass Insert Elbow • Spec Sheet



*Product will have LF imprinted on the body for Lead Free

FEATURES & BENEFITS

- Lead Free Brass*
- Insert x Insert Adapter
- Rating Pressure 150 PSI
- Sizes 3/4" – 1-1/2"

MATERIAL SPECIFICATIONS

Part	Material
Body	Brass C46400

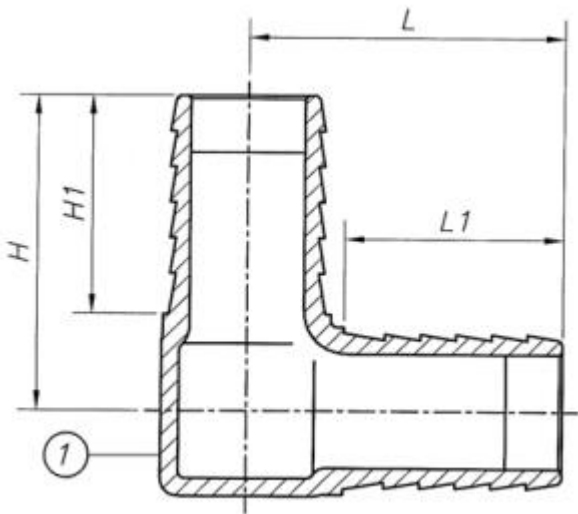

DIMENSIONS

Part	Size	Barb	L	L1	H	H1
IBIL04LF	3/4"	5	1.75	1.21	1.75	1.21
IBIL05LF	1"	5	1.99	1.21	1.99	1.21
IBIL06LF	1-1/4"	6	2.43	1.41	2.43	1.41
IBLR0705LF	1-1/2" X 1"	6	2.29	1.41	2.46	1.41



*This product complies with 0.25% weighted average lead content on wetted surfaces in accordance with the Safe Drinking Water Act (SDWA) / Federal Public Law No. 111-380.

Global sourcing. National compliance. Local service.

CALIFORNIA 5593 Fresca Dr., La Palma CA 90623 • Toll Free: 866-532-8306 • Fax: 866-532-8307
TEXAS 1150 Silber Rd., Houston TX 77055 • Toll Free: 800-935-5456 • Fax: 713-680-2999
NEW YORK PO Box 27, Rt. 22, Brewster NY 10509 • Toll Free: 800-431-2082 • Fax: 845-278-9056
 WEB: www.matco-norca.com EMAIL: mail@matco-norca.com