

FY-750 Bathcock • Spec Sheet

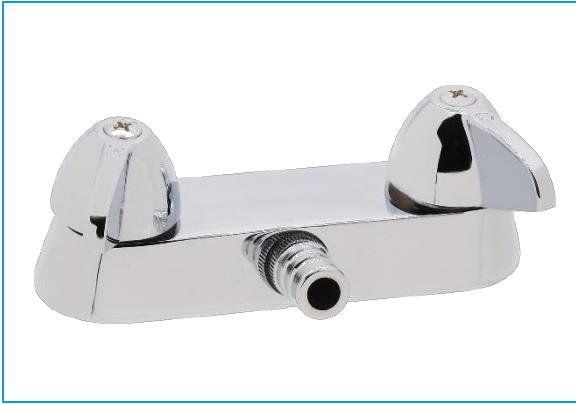

FEATURES & BENEFITS

- Bathcock For Claw Foot Tub
- 3-3/8"
- Chrome
- UPC Approved

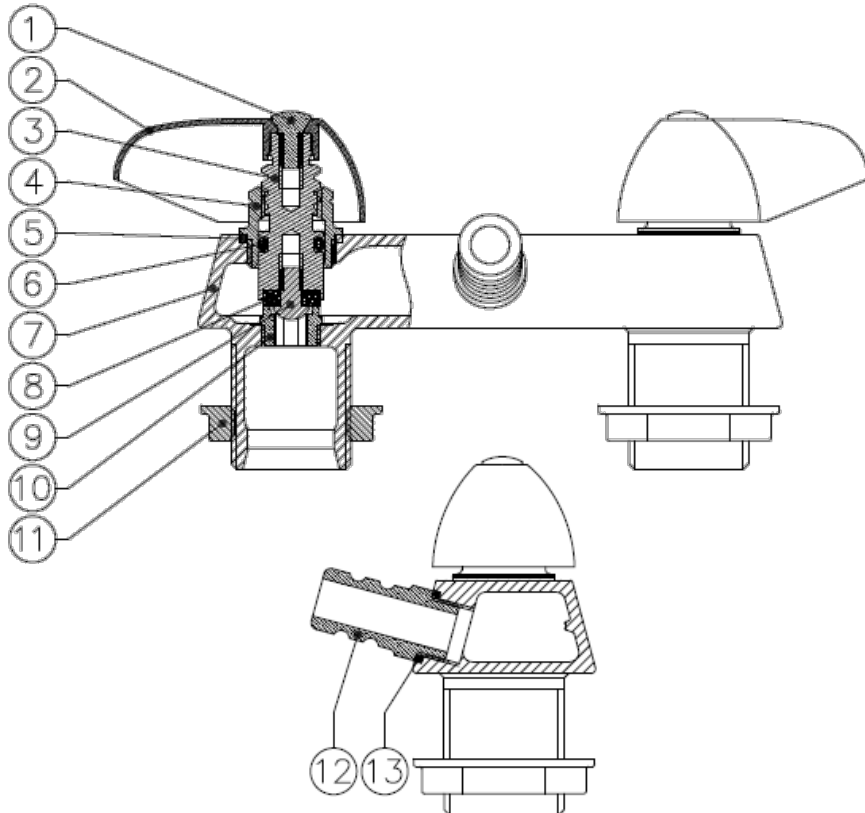

MATERIAL SPECIFICATIONS

No.	Part	Material
1	Screw	Brass C37700
2	Handle	Zinc
3	Stem	Brass C89550
4	Shell	Brass C89550
5	Washer	Nylon
6	O-Ring	BUNA SN-719F
7	Body	Brass C89550
8	Washer	EPDM SE-719F
9	Screw	Brass C37700
10	Sealing Seat	Brass C89550
11	Nut	Brass C37700
12	Spout	Brass C89550
13	O-Ring	BUNA SN-719F

