

DWV Trap Adapter

Specification Sheet

FEATURES & BENEFITS

- Cast Brass
- SWT x Slip Trap Adapter



MATERIAL SPECIFICATIONS

No.	Part	Material
1	Nipple	Brass B584 C85710
2	Packing	POM M90
3	Packing Nut	Brass B584 C85710

DIMENSIONS

Part #	Size	D	H
DWV-07TA	1-1/2"	2.03	1.29

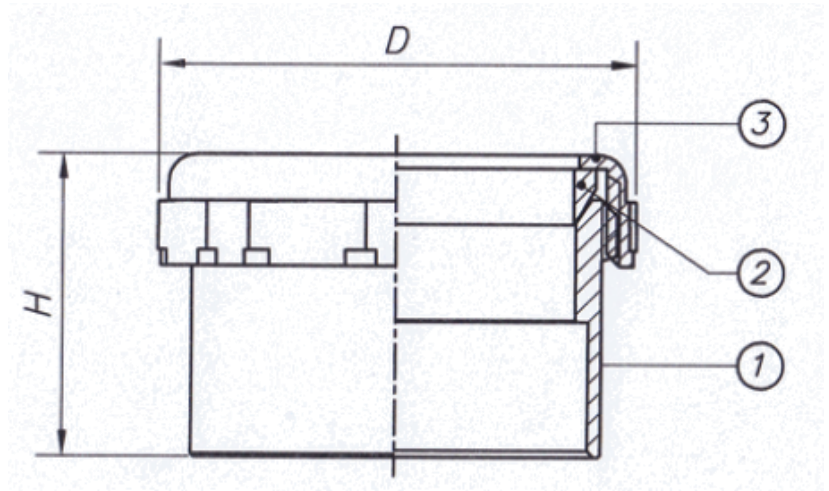

DWV Adapter Bushings

Specification Sheet



FEATURES & BENEFITS

- Cast Brass
- SWT x Male Adapter Bushing



DWV-07A – 1-1/2"

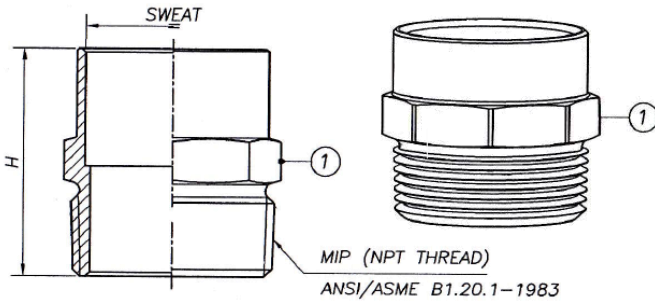

DWV-08A – 2"

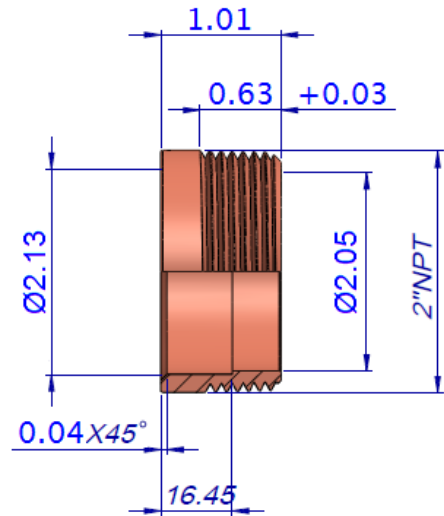

MATERIAL SPECIFICATIONS

No.	Part	Material
1	Body	Cast Brass C85700

DIMENSIONS

D	H	MIP (NPT Thread)
1.87	2.13	1-1/2"-11.5NPT

