

# CL-308CS Wallmount Kitchen Faucet • Spec Sheet



## FEATURES & BENEFITS

- 8" Two Handle
- Metal Lever Handles
- 8" Cast Spout
- With Soap Dish
- Chrome
- UPC & ADA Approved

## MATERIAL SPECIFICATIONS

No.	Part	Material
1	Outlet	Brass C37700
2	Gasket	EPDM
3	Cap	Brass C37700
4	Steel Bridge	POM
5	Cover	POM
6	Gasket	POM
7	Wire Mesh	Stainless Steel 304
8	Plastic Sheet	POM
9	Screw	Stainless Steel 304
10	Handwheel	Zinc
11	Stem	Brass C89550
12	Cap Nut	Brass C37700
13	O-Ring	EPDM
14	Body	Brass C89550
15	Gasket	EPDM
16	Crossed Screw	Brass C89550
17	Check Core	Brass C89550
18	Nut	Brass C37700
19	Gasket	EPDM
20	Buckle	Stainless Steel 304
21	Connector	Brass C89550
22	O-Ring	BUNA SN-719F
23	Gasket	Nylon
24	Nut	Brass C37700
25	Connector	Brass C89550
26	O-Ring	BUNA SN-719F
27	Soap Dish	Zinc
28	Stand	Zinc

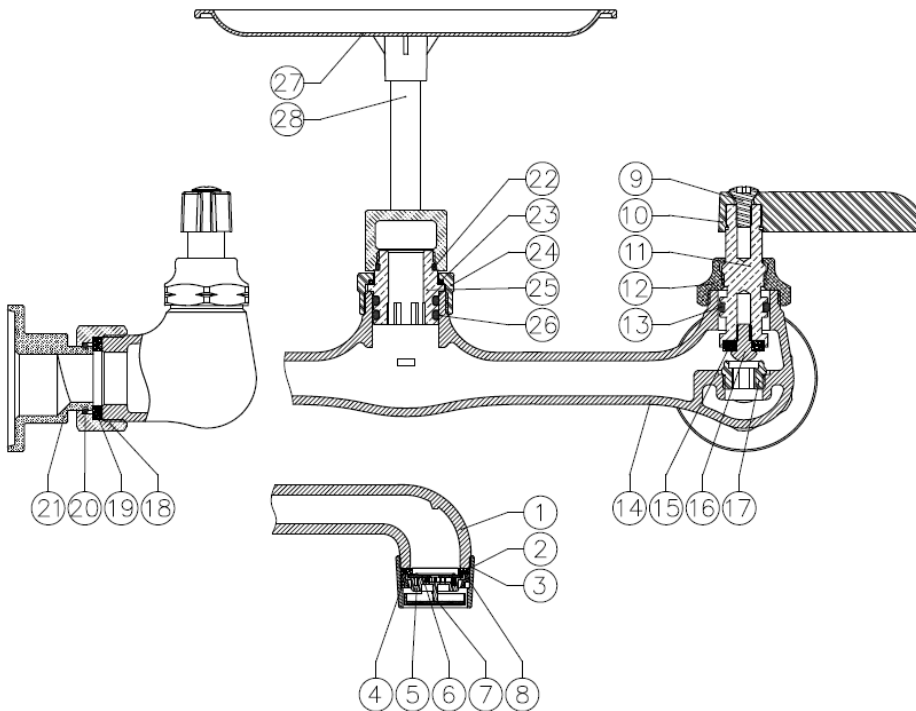

\* These product complies with 0.25% weighted average lead content on wetted surfaces in accordance with Safe Water Drinking Act (SDWA) / Federal Public Law No. 111-380.

Global sourcing. National compliance. Local service.

**CALIFORNIA** 5593 Fresca Dr., La Palma CA 90623 • Toll Free: 866-532-8306 • Fax: 866-532-8307  
**TEXAS** 1150 Silber Rd., Houston TX 77055 • Toll Free: 800-935-5456 • Fax: 713-680-2999  
**NEW YORK** PO Box 27, Rt. 22, Brewster NY 10509 • Toll Free: 800-431-2082 • Fax: 845-278-9056  
 WEB: [www.matco-norca.com](http://www.matco-norca.com) EMAIL: [mail@matco-norca.com](mailto:mail@matco-norca.com)