

CIFD Adjustable Shower Drain • Spec Sheet

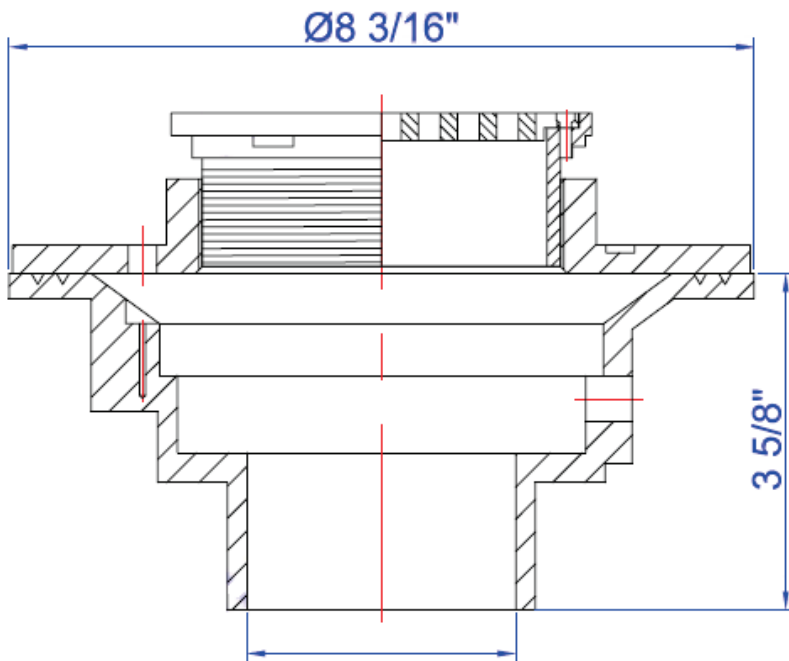

FEATURES & BENEFITS

- Epoxy Coated Cast Iron Body
- Epoxy Coated Clamping Ring
- Adjustable Chrome Plated Brass Strainers Body



| Part # | Size & Description |
|-----------|--------------------|
| CIFD15NH2 | 2" No Hub |
| CIFD15NH3 | 3" No Hub |
| CIFD15NH4 | 4" No Hub |

MATCO-NORCA

Global sourcing. National compliance. Local service.

CALIFORNIA 5593 Fresca Dr., La Palma CA 90623 • Toll Free: 866-532-8306 • Fax: 866-532-8307
TEXAS 1150 Silber Rd., Houston TX 77055 • Toll Free: 800-935-5456 • Fax: 713-680-2999
NEW YORK PO Box 27, Rt. 22, Brewster NY 10509 • Toll Free: 800-431-2082 • Fax: 845-278-9056
 WEB: www.matco-norca.com EMAIL: mail@matco-norca.com