

70SSTH S.S. Threaded Y Strainer • Spec Sheet



FEATURES & BENEFITS

- W.P. 800WOG
- W.T. -4°F - 392°F
- 316 Stainless Steel Body
- 40 Mesh Screen
- Investment Casting
- Swing Type Disc
- Thread Type: NPT
- Sizes 1/2" - 2"

MATERIAL SPECIFICATIONS

No.	Part	Material
1	Body	Stainless Steel 316
2	Screen	Stainless Steel 304
3	Gasket	PTFE
4	Cap	Stainless Steel 316
5	Stopper	Stainless Steel 316
6	Gasket	PTFE

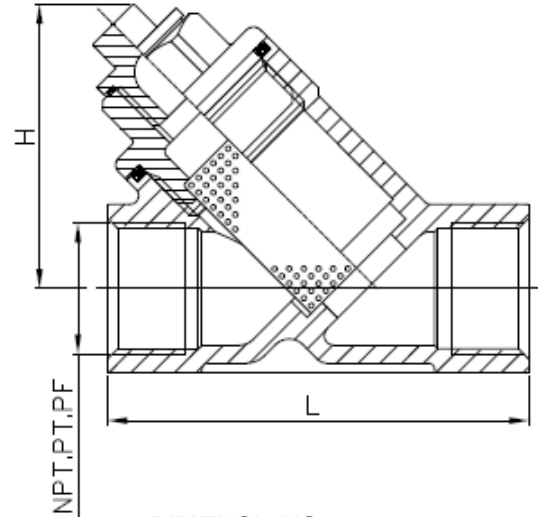
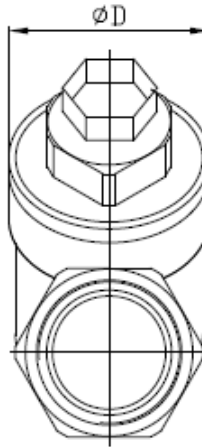
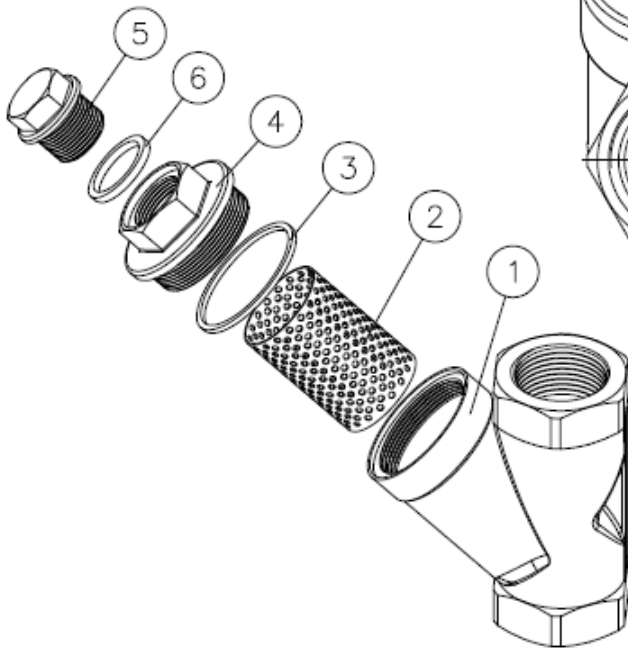

DIMENSIONS

Part #	Size	L	H	D	Weight (lb)
70SSTH03	1/2"	2.56	1.77	1.22	0.53
70SSTH04	3/4"	3.15	2.09	1.42	0.79
70SSTH05	1"	3.55	2.68	1.77	1.52
70SSTH06	1-1/4"	4.14	2.84	1.97	1.90
70SSTH07	1-1/2"	4.73	3.15	2.32	2.98
70SSTH08	2"	5.52	3.82	2.96	5.22



CALIFORNIA 5595 Fresca Dr., La Palma CA 90623
TEXAS 1150 Silber Rd., Houston TX 77055
ILLINOIS 278 Windy Point Dr., Glendale Heights, IL 60139
GEORGIA 113 Industrial Blvd., Americus, Georgia 31709
NEW YORK PO Box 27, Rt.22, Brewster NY 10509
 WEB: www.matco-norca.com

• Phone: 866-532-8306 • Fax: 866-532-8307
 • Phone: 800-935-5456 • Fax: 713-680-2999
 • Phone: 844-412-5068 • Fax: 800-640-2252
 • Phone: 800-433-7526 • Fax: 800-533-5134
 • Phone: 800-431-2082 • Fax: 845-278-9056
 EMAIL: mail@matco-norca.com