

203TF Bent Nose Garden Valve • Spec Sheet



FEATURES & BENEFITS

- ISO-9002
- 125 WOG
- Brass Body
- Hose x FIP
- Sizes 1/2" - 1"

DIMENSIONS

Part #	Size
203TF3	1/2" Female x 3/4" MHT
203TF4	3/4" Female x 3/4" MHT
203TF5	1" Female x 3/4" MHT

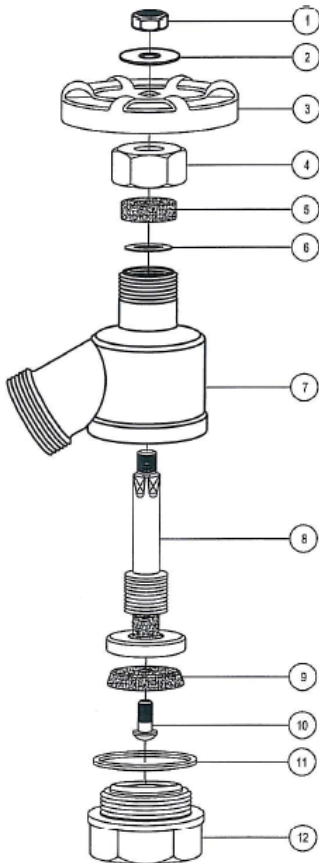

MATERIAL SPECIFICATIONS

No.	Part	Material
1	Wheel Nut	Hot Rolled SAE 1010R
2	Name Plate	Aluminum
3	Handle Wheel	Cast Iron
4	Packing Nut	Brass B124 C37700
5	Packing	Rubber SAE No 1052#
6	Washer	Stainless Steel 304/306
7	Body	Brass B584 C85710
8	Stem	Brass B584 C85710
9	Seat Packing	Rubber SAE No 1052#
10	Seat Screw	Brass B124 C37700
11	Packing	Fibre
12	Bonnet	Brass B584 C85710

 **MATCO-NORCA**
Global sourcing. National compliance. Local service.

CALIFORNIA 5593 Fresca Dr., La Palma CA 90623 • Toll Free: 866-532-8306 • Fax: 866-532-8307
TEXAS 1150 Silber Rd., Houston TX 77055 • Toll Free: 800-935-5456 • Fax: 713-680-2999
NEW YORK PO Box 27, Rt. 22, Brewster NY 10509 • Toll Free: 800-431-2082 • Fax: 845-278-9056
 WEB: www.matco-norca.com EMAIL: mail@matco-norca.com