

140S Cast Iron Y Strainer • Spec Sheet



FEATURES & BENEFITS

- Y Strainer-Threaded Ends
- Class 250 / 250 WSP
- Cast Iron Body
- 360 PSI Non-Shock CWP @ 150° F
- 250 PSI WSP @ 300 ° F
- Sizes 1/4" - 2" 20 Mesh S.S. Screen
- Sizes 2 1/2" - 3 3/4" Perforated S.S. Screen

STANDARD SCREENS

Size	Opening	Std. Mesh / Perf
1/4" - 2"	0.032"	20 Mesh
2-1/2" - 3"	0.045"	3/64" Perf

MATERIAL SPECIFICATIONS

No.	Part	Material
1	Body	Cast Iron
2	Cover	Cast Iron
3	Screen	Stainless Steel - ASTM A126 WCB
4	Gasket	PTFE
5	Plug	Carbon Steel - ASTM A276 304

DIMENSIONS

Part #	Size	L	A	B	Blow-Off N.P.T
140S01	1/4"	3.19	1.97	3.94	1/4"
140S02	3/8"	3.19	1.97	3.94	1/4"
140S03	1/2"	3.19	1.97	3.94	3/8"
140S04	3/4"	3.74	2.68	5.40	1/2"
140S05	1"	4.02	2.99	5.99	1/2"
140S06	1-1/4"	5.08	3.43	6.90	3/4"
140S07	1-1/2"	5.75	3.78	7.56	3/4"
140S08	2"	7.01	4.33	8.71	1"
140S09	2-1/2"	9.26	6.11	12.21	1-1/4"
140S10	3"	10.01	7.41	14.81	1-1/2"

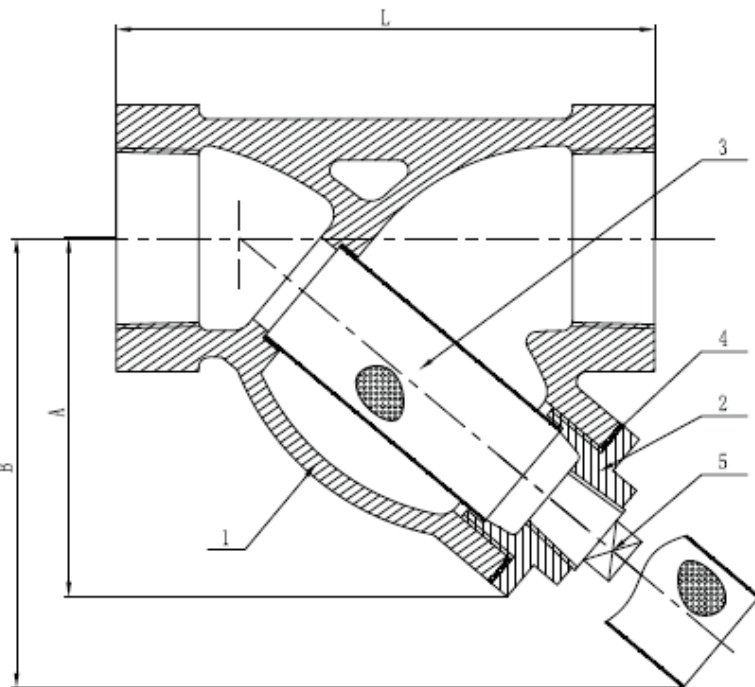

Global sourcing. National compliance. Local service.

CALIFORNIA 5593 Fresca Dr., La Palma CA 90623 • Toll Free: 866-532-8306 • Fax: 866-532-8307
TEXAS 1150 Silber Rd., Houston TX 77055 • Toll Free: 800-935-5456 • Fax: 713-680-2999
NEW YORK PO Box 27, Rt. 22, Brewster NY 10509 • Toll Free: 800-431-2082 • Fax: 845-278-9056
 WEB: www.matco-norca.com EMAIL: mail@matco-norca.com